

Airmax (formerly Air Pro) Model ERD60 A, B, C Rockdrill
Chuck Sizes for Models A: 7/8 x 3-1/4", B: 7/8 X 4-1/4", C: 1 X 4-1/4"

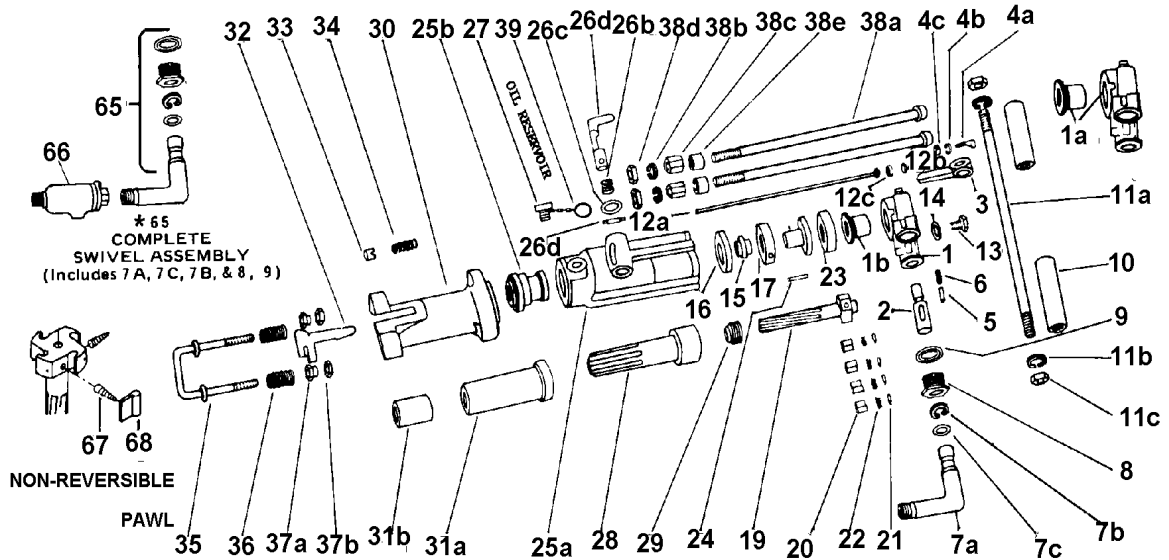

Item No.	Part No.	Description	Item no.	Part No.	Description
1	67564	Backhead-Bare	28	S55-9	Piston
1A	S55-2F	Backhead w/bushing	29	S55-25-35	Nut-Rifle Bar/Piston
1B	S55-2CD	Bushing f/backhead	30	S55-17A	Fronthead 7/8" x 3 1/4"
2	S55-12B	Valve-Throttle		S55-17LA	Fronthead 7/8 & 1" x 4 1/4"
3	S55-12	Lever, Throttle Valve	31A	S55-7	Driver-Chuck 7/8 x 3 1/4"
4A	S55-12C	Bolt, Throttle Lever		S55-7B	Driver-Chuck 7/8 x 3 1/4"
4B	WP-14	Lockwasher, T.Lever Bolt	31B	S55-7L-A	Bushing-Chuck 7/8" x 3 1/4"
4C	NJ-5	Nut, T.Lever Bolt		S55-7LL-B	Bushing-Chuck 7/8" x 3 1/4"
5	7-2A	Plunger, T. Valve		S55-7LL-F	Bushing-Chuck 1" x 4 1/4"
6	7-2ES	Spring, Detent Plunger	32	S55-36RA	Retainer
7A	RB-183-47	Swivel-Air Inlet 3/4" NPTM	33	S55-36E	Pivot-Steel Retainer
7B		Retainer, Air Inlet	34	S55-36SA	Spring-Steel Retainer pivot
7C	OR-21	O Ring, Air Inlet Swivel	35	S55-36J	Yoke, Steel Retainer (7/8 x 3-
			35	0550060	Yoke, Retainer(1" or 7/8 x 4-1/4)
8	S48-146G	Nut, Air Inlet Swivel	36	S73-36S	Spring-Yoke
9	S48-146W	Washer, swivel nut	37A	S55-36WB	Nut-Yoke, Lower
10	S55-34	Grip, Handle, Rubber	37B	NFC-6	Nut-Yoke, Upper
11A	S55-35	Bolt, Grip Handle	38A	S55-3E	Rod-Side
11B	S55-34W	Washer, handle BOLT	38B	D79-36W	Lockwasher, Side Rod
11C	ESC-12	Nut, Handle Bolt	38C	D79-3N	Nut-Side Rod, Long
12A	S55-27A-27B	Tube, Dry	38D	NJ-10	Nut-Side Road, Short
12B	17-39A	Washer-Metal	38E	D79-35	Spacer-Side Rod
12C	7-29B	Seal-Rubber	39	67539	Chain Oil Plug
13	107-29	Gland, Backhead	65	S48-147GX	Swivel Assembly
14	WC-1	Washer-Gland	66	67045	Oiler
15	S55-16A	Valve, Automatic	67	S55-11C	Spring-Pawl
16	S55-15A	Seat, Automatic Valve	68	90-11A	Pawl-Rotation
17	S55-15BA	Chest, Automatic Valve	69	S55-27C	Tube-Water
18	S55-15CA	Plug, Automatic Valve	70	D93-13X	Swivel Assembly
19	S55-26-35	Bar-Rifle	71	67571	Gland, Backhead
20	R91-11A	Pawl-Rotation Reversible	72	67572	Stem Fitting, Gland/swivel nut
21	7-11-B	Plunger-Pawl	73	67573	Elbow, Stem Fittin, water
22	7-11-C	Spring, Pawl Plunger	74	67574	Nipple Hose
23	S55-33	Ring, Ratchet	75	67575	Hose, Water
24	S55-33P	Pin, Dowel, Ratchet Ring	76	67576	Clamp-Hose Band
25A	S55-1	Cylinder, Bare	80	S55-2WA	Backhead with Bushing
25B	S55-1B	Bushing, Cylinder	81	S55-2CA	Bushing, Backhead
26A	S55-1VC	Valve, Exhaust Control	82	PP-5	Plug-Water swivel Assy.
26B	S55-1S	Spring Exhaust Control	83	67853	Screen, Water Swivel Assembly
26C	S55-1W	Washer, Exhaust Control	84	67854	O-Ring
26D	S55-1C	Pin, Exhaust Control	85	67585	Nut, Water Swivel
27	H81-28	Plug, Oil Reservoir	86	7-60	Valve, Water